

**WEAVER<sup>®</sup>**

**Model WA-75B**  
**Parts List and Breakdown**

**Weaver Jack Corporation**  
**343 Lawrence Street**  
**Adrian, MI 49221**  
**(517) 263-6500**

# WA-75B Parts Breakdown

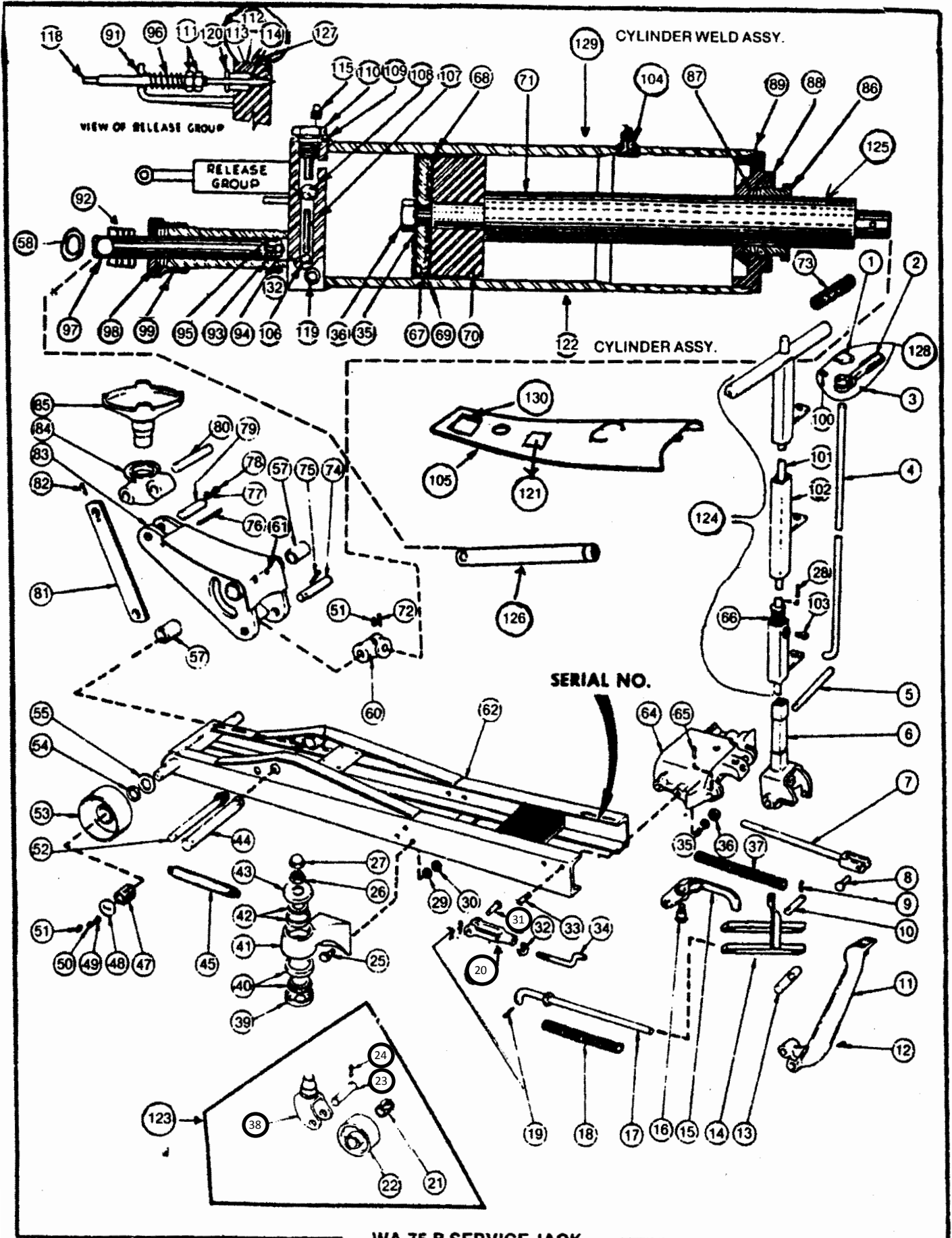

## WA-75B Repair Parts List

ITEM #	PART #	DESCRIPTION	ITEM #	PART #	DESCRIPTION
1.	S-7075	RELEASE LOCK	66.	S-2329	LOCK RETURN SPRING
2.	M-1157	RELEASE HANDLE	67.	S-5181	RAM CUP WASHER
3.	S-23689	ROLL PIN	68.	S-24649	RAM CUP
4.	S-5261	RELEASE ROD	69.	S-24703	RING
5.	S-6551	HANDLE PIN	70.	M-1154	RAM HEAD
6.	M-1414	HANDLE YOKE	71.	S-24709	PISTON ROD
7.	AS-20495	RETURN GUIDE ASSEMBLY	72.	S-3083	COTTER PIN 3/16 X 2-3/4
8.	S-5263	HANDLE RETURN PIN	73.	S-20886	HANDLE GRIP
9.	S-107	CLEVIS PIN	74.	S-24707	CROSSHEAD PIN
10.	S-24659	CLEVIS PIN	75.	S-3234	COTTER PIN 3/16 X 2
11.	M-1416	FOOT LEVER	76.	S-6577	SECTOR SPRING KEY
12.	S-5098	SET SCREW 1/4 NC X 5/8	77.	S-10189	LOCKWASHER 1/4 INT
13.	S-6552	FOOT LEVER PIN	78.	S-160	MACH SCW 1/4-20 NC X 3/8
14.	M-2237	PUMP LINK ASSEMBLY	79.	S-6580	LIFTING ARM PIN
15.	M-1148	RELEASE LEVER	80.	S-5158	PARALLEL ARM PIN
16.	S-6586	RELEASE LEVER PIN	81.	S-24651	PARALLEL ARM
17.	S-27385	PLUNGER RETURN ROD	82.	S-16099	COTTER PIN 3/16 X 2-1/4
18.	S-9786	PLUNGER RETURN SPRING	83.	AS-24654	LIFTING ARM ASSEMBLY
19.	S-275	COTTER PIN 1/8 X 3/4	84.	M-1433	SADDLE BRACKET
20.	S-5123	RELEASE CLEVIS	85.	M-1159	SADDLE
21.	S-15398	ROLLER BEARING	86.	M-1427	PISTON PACKING NUT
22.	M-1152	CASTER WHEEL	87.	S-6615	PISTON ROD PACKING
23.	S-711	CASTER AXLE	88.	M-1426	CYLINDER GAP
24.	S-293	COTTER PIN 3/16 X 1	89.	S-22963	GASKET
25.	S-24751	12 PT CAP SCW 1/2-20UNF X 1-1/4	91.	S-5173	RELEASE VALVE GUIDE
26.	S-2232	HEX JAM NUT 3/4-16 UNF	92.	S-8624	LEVER FRICTION SPRING
27.	S-6605	HEX ACORN NUT 3/4-16 UNF	93.	S-7413	BACK-UP WASHER
29.	S-3008	INT LOCKWASHER 1/2	94.	S-24648	PUMP CUP LEATHER
30.	S-9522	HEX NUT 1/2-20 UNF	95.	S-24690	RING
31.	S-4710	RELEASE YOKE PIN	96.	S-2591	RELEASE SPRING
32.	S-1863	HEX NUT 5/16-24 UNF	97.	S-24497	PUMP PLUNGER
33.	S-5014	CAP SCW 1/2-13 NC X 2-3/4	98.	S-7412	PLUNGER PACKING
34.	S-6576	RELEASE PULL ROD	99.	M-1167	PUMP PACKING NUT
35.	S-512	LOCKWASHER 1/2	100.	S-23872	SQ HD SET SCW 1/4 UN X 3/4
36.	S-508	HEX NUT 1/2-13 UNC	101.	AS-6550	LOCK ROD ASSEMBLY
37.	S-1365	RETURN SPRING	102.	AS-6660	HANDLE ASSEMBLY
38.	M-2030	CASTER YOKE	103.	S-102	SQ HD SET SCW 3/8 UNC X 3/4
39.	S-15429	STAMPED CLOSURE	104.	S-5178	FILLER PLUG
40.	AS-15815	LOWER BEARING ASSEMBLY	105.	AS-12393	COVER PLATE
41.	M-2028	CASTER BRACKET	106.	S-3282	BALL 7/16
42.	AS-15814	UPPER BEARING ASSEMBLY	107.	S-5355	INTAKE BALL WEIGHT
43.	S-24650	CASTER BEARING CAP	108.	S-5122	BALL 5/8
44.	S-28009	SECTOR PIN	109.	S-5125	PLUG GASKET
45.	S-6603	SECTOR SPRING	110.	S-16196	BALL CHAMBER PLUG
47.	S-11103	FRONT WHEEL BEARING	111.	S-1934	HEX JAM NUT 3/8-16 UNC
48.	S-9147	FRONT WHEEL RETAINER	112.	S-15047	O-RING 1/4
49.	S-543	LOCKWASHER 1/4	113.	S-21051	PACKING HOUSING
50.	S-1877	CAP SCW 1/4-20 NC X 3/4	114.	S-17829	O-RING 3/8
51.	S-5096	GREASE ZERK 1/8 NPT	115.	S-1805	PIPE PLUG 1/8
52.	S-24706	PARALLEL BAR PIN	118.	S-21050	RELEASE VALVE
53.	AS-12588	FRONT WHEEL ASSEMBLY	119.	S-5652	PIPE PLUG 3/8
54.	S-5200	INSIDE HUB WASHER	120.	S-5176	RELEASE PACKING NUT
55.	S-9149	INSIDE WHEEL WASHER	121.	S-24747	GOV'T PLATE
57.	S-6592	BUSHING	122.	AS-24691A	CYLINDER ASSEMBLY
58.	S-19990	LEVER SPRING WASHER	123.	AS-24621	CASTER ASSEMBLY
60.	M-1158	CROSSHEAD	124.	AS-6545	HANDLE ASSEMBLY
61.	S-6593	LIFT ARM BUSHING RETAINER	125.	AS-24494	PISTON ROD ASSEMBLY
62.	AS-24658A	FRAME ASSEMBLY	126.	AS-24498	PUMP PLUNGER ASSEMBLY
64.	M-1423	TIE CASTING	127.	AS-21052	PACKING ASSEMBLY
65.	S-15694	ROLL PIN	128.	AS-22107	RELEASE HANDLE ASSEMBLY

## WA-75B Repair Parts List

ITEM #	PART #	DESCRIPTION
129.	AS-24485A	CYLINDER SHELL
130.	S-28082	NAME PLATE